

S:\4389 - CCHD - CITIZENS DOCK REPAIRS\CivilSD\20160518 - 4389 CCHD - CITIZENS DOCK REPAIR STAGING AREA.dwg 5/19/2016 3:38 PM STOVER ENGINEERING SHALL NOT BE RESPONSIBLE FOR THE ACCURACY OR COMPLETENESS OF ELECTRONIC COPIES OF THIS PLAN SHEET.

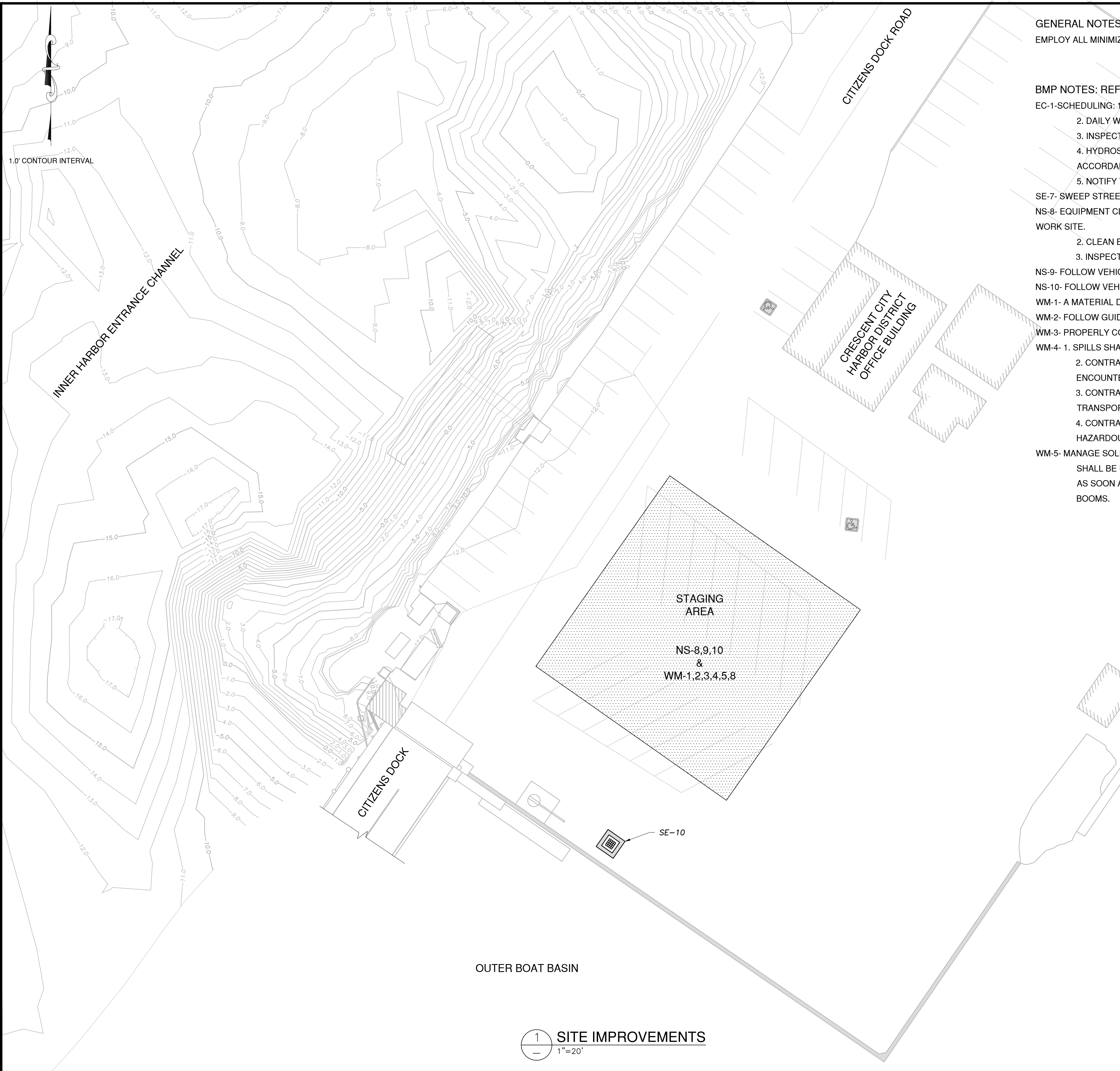

GENERAL NOTES:

EMPLOY ALL MINIMIZATION MEASURES IDENTIFIED IN THE BIOLOGICAL ASSESSMENT DATED NOVEMBER 24, 2008.

BMP NOTES: REFERENCE THE CALIFORNIA STORM WATER BMP HANDBOOK, CASQA2003

- EC-1-SCHEDULING: 1. ALL WORK IN WATER SHALL BE PERFORMED BETWEEN JULY 1 AND OCTOBER 15.
 2. DAILY WORK ACTIVITIES SHALL BE SCHEDULED SUCH THAT IN WATER WORK I PERFORMED AT LOW TIDE.
 3. INSPECT ALL BMP'S DAILY.
 4. HYDROSEEDING OF EXPOSED SOIL SHALL BE COMPLETED AS SEGMENTS OF THE WORK ARE FINISHED IN ACCORDANCE WITH EC-4. MANUAL SEEDING MAY BE APPROVED BY CONSTRUCTION MANAGER.
 5. NOTIFY THE REGIONAL WATER BOARD AT LEAST FIVE DAYS PRIOR TO GROUND DISTURBANCE.
 SE-7- SWEEP STREETS AT THE END OF EACH DAY.
 NS-8- EQUIPMENT CLEANING: 1. ALL EQUIPMENT SHALL BE THOROUGHLY WASHED PRIOR TO BEING DELIVERED TO THE WORK SITE.

2. CLEAN EQUIPMENT AFTER FUELING & PERFORMING MAINTENANCE.
 3. INSPECT EQUIPMENT REGULARLY & CLEAN AS NEEDED.
 NS-9- FOLLOW VEHICLE AND EQUIPMENT FUELING PRACTICES IDENTIFIED.
 NS-10- FOLLOW VEHICLE AND EQUIPMENT MAINTENANCE PRACTICES IDENTIFIED.
 WM-1- A MATERIAL DELIVERY AND STORAGE STATION SHALL BE USED FOR ALL MATERIAL DELIVERED.
 WM-2- FOLLOW GUIDELINES FOR MATERIAL USE.
 WM-3- PROPERLY COVER & BURM ALL STOCKPILES.
 WM-4- 1. SPILLS SHALL BE PREVENTED & CONTROLLED TO THE EXTENT PRACTICABLE.
 2. CONTRACTOR SHALL NOTIFY THE REGIONAL WATER BOARD IMMEDIATELY AND WITHIN 24 HOURS OF ENCOUNTERING WASTES DURING THE PROJECT.
 3. CONTRACTOR SHALL PREPARE APPLICABLE ENGINEERED PLANS FOR HANDLING, TREATING AND TRANSPORTING OF WASTES.
 4. CONTRACTOR SHALL PROVIDE CERTIFICATION THAT A REGISTERED FIRST RESPONSE PROFESSIONAL HAZARDOUS MATERIALS CLEAN UP/ REMEDIATION SERVICE IS LOCALLY AVAILABLE ND ON CALL.
 WM-5- MANAGE SOLID WASTES IN A TIMELY FASHION. REMOVE TRASH AND CONTAIN PROPERLY. FLOATING BOOMS SHALL BE USED TO CONTAIN DEBRIS DISCHARGED INTO COASTAL WATERS. ANY DEBRIS SHALL BE REMOVED AS SOON AS POSSIBLE BUT NO LATER THAN THE END OF EACH DAY. SILT CURTAIN CAN BE COMBINED WITH BOOMS.

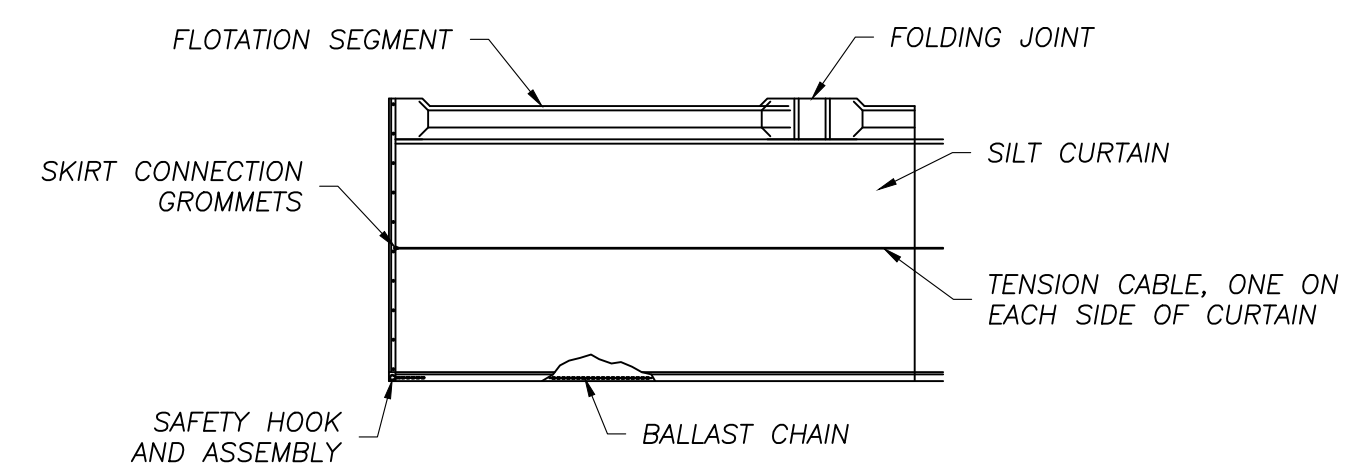

2 (TYP) FLOATING BOOM W/ OPTIONAL SILT CURTAIN
 NTS

1 SITE IMPROVEMENTS
 1"=20'

| No. | Date | Revision | Apprv. |
|-----|------|----------|--------|
| | | | |

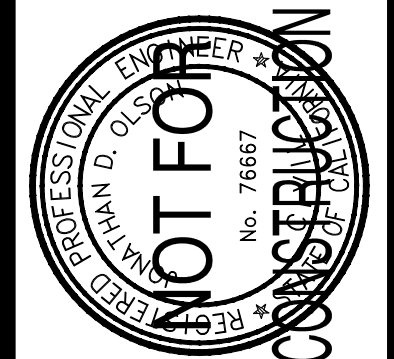

STOVER ENGINEERING
 Civil Engineers and Consultants
 PO BOX 783 - 711 H STREET
 CRESCENT CITY, CA 95531 707-465-6742

CRESCENT CITY HARBOR DISTRICT
 CITIZENS' DOCK REPAIRS
 CRESCENT CITY, CA
 CONSTRUCTION STAGING AREA

JOB NO. 4389
 SCALE: 1"=20'
 DATE: 05/18/16
 SHEET
1 OF **1**